



SeaSport

BUILT FOR YOUR ADVENTURE | SEA SPORT BOATS BROCHURE





HANDMADE IN THE PACIFIC NORTHWEST

We've had over 60 years of experience perfecting the Sea Sport boat lines cruising around the world. Let our legacy make your travels memorable.

SERIES

6

MODELS

11

MADE IN THE

USA

CONFIGURATIONS

INFINITE



2200 SERIES

The biggest little boat with all the oomph



2400 SERIES

All the bells and whistles fish love



2600 SERIES

The perfect mix of performance, durability and comfort



2800 SERIES

The ultimate in recreation



3000 SERIES

Go forth and play in our newly redesigned 3000 series



3200 SERIES

Cat-like reflexes while providing a stable and efficient ride

TABLE OF CONTENTS

WHY SEA SPORT	06	Kodiak 2600	30
HISTORY	10	2800 SERIES	32
2200 SERIES	12	Commander 2800	34
Sportsman 2200	14	3000 SERIES	36
2400 SERIES	16	Offshore 3000	38
Explorer 2400	18	Voyager 3000	40
XL 2400	20	3200 SERIES	42
2600 SERIES	22	Pacific 3200	44
Alaskan Pilot 2600	24	CUSTOMIZATION OPTIONS	46
Aleutian 2600	26	STANDARD FEATURES	52
Kenai 2600	28	WARRANTY	55







WHY SEA SPORT?

EXPLORATION AND RELAXATION

Explore the water without borders and reach places that make others jealous. We strive to give you the confidence behind the wheel so you can concentrate on fun, not repairs and nerves. With a gigantic hard-top for dinghy and kayak storage and large windows with 360 degree cabin visibility, Sea Sport wants to make sure you enjoy each outing comfortably.



GREAT FAMILY FUN

Making memories is what being on the water is all about. Sea Sport has a great family tradition, and we've tried to put that same pride and focus into how these boats can be used. Get away for the weekend and enjoy your great sound system for entertaining and there's plenty of storage for snacks and beverages.

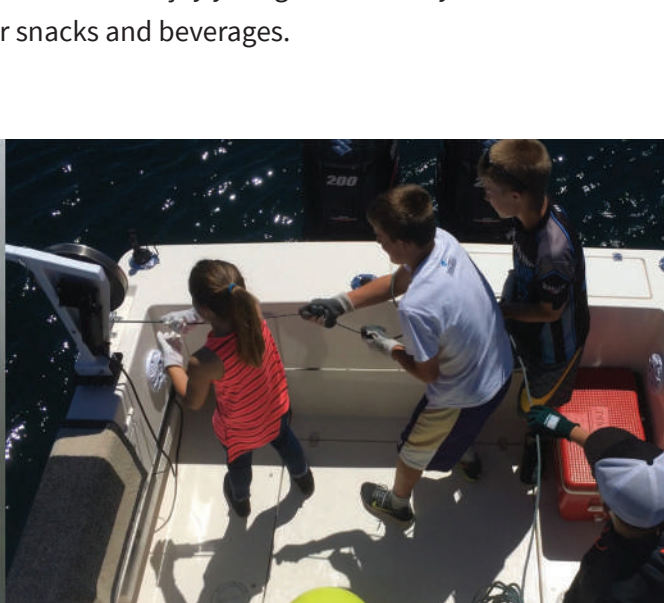



FULLY RIGGED FISHING MACHINE

Fishing in the Pacific Northwest and Alaska for over a half century has led us to produce the pinnacle of all fishing boats. From thoughtful layouts built for convenience and success to storage for everything from rods, tackle, nets, and bonkers, our Sea Sports are dependable and spacious.

SEA SPORT CHRONOLOGY

1955 WRIGHT MANUFACTURING BEGINS MANUFACTURING BOATS

The original factory was established at 915 Harris Avenue in Fairhaven, Washington. This is where the first Sportsman was introduced, a 12' model called the Cartopper.

- | | | | |
|-------------|---|-------------|--|
| 1957 | 16' Sportsman introduced | 1973 | Changed name to Wright Brothers Incorporated |
| 1958 | 8' Sportsman introduced | 1977 | Moved to a new facility on the Guide Meridian |
| 1959 | 12' Sportsman with rolled edge and small deck introduced as well as the 10' Sportsman | 1979 | 21' Sportsman introduced |
| 1960 | 14' Sportsman introduced | 1983 | First 22' Sea Sport introduced |
| 1961 | 8' sailing dinghy introduced | 1985 | The first forward-facing windows were introduced on the 27' Pilot. Following that, all Sea Sport boats featured the now iconic forward-facing windows. |
| 1962 | 10' 3-piece Sportsman introduced | 1986 | First 27' Sea Sport Seamaster introduced |
| 1963 | Moved the factory to a bigger facility at 212 McKenzie Avenue | 1988 | First 27' Sea Sport Navigator introduced |
| 1964 | 18' Sportsman introduced | 1994 | First 24' Sea Sport Explorer introduced |
| 1965 | 18' Sportsman Cuddy cabin introduced | 1998 | First 32' Sea Sport Pacific introduced |
| 1968 | 10' and 14' Sportsman re-designed | | |

- 2000** Due to health concerns, Wright Brothers sold to the Lindhouts (Boondock's Boats and Motors).
- 2002** 30' Voyager introduced
- 2003** 30' Offshore introduced and the company acquires the assets of Osprey Boats.
- 2005** First Osprey introduced. For Sea Sport, the names for the 26' models changed and the Kodiak introduced the new deep v-hull for the 26' / 27' hulls.
- 2008** The company acquires the assets to C-Dory Boats
- 2009** First C-Dory introduced
- 2011** Triton Marine begins operation in Ferndale, WA producing Osprey, C-Dory and Skagit Orca
- 2012** Wright family (Mark Wright, Ryan Binning, Ron Wright) acquires Triton Marine and begins production of Sea Sport, C-Dory, Osprey and Skagit Orca.
- 2013** The business decision is made to close Triton Marine. A new company is formed, Northwest Marine Industries (NMI), which will produce all 4 brands.
- 2014** September 11th, a catastrophic fire occurred at the Ferndale plant. On November 6th, NMI re-opened for production at 809 Harris Ave; 500 yards from the original factory.
- 2017** Reintroduction of the Sea Sport Pacific 32' with outboard power
- 2018** Reintroduction of the Sea Sport 30' Voyager







2200 SERIES

THE BIGGEST
LITTLE BOAT WITH
ALL THE OOMPH

MODELS

1

POWER OPTIONS

5

CONFIGURATIONS

2



SPORTSMAN 2200

AGGRESSIVE APPROACH

This boat has great versatility. Whether you're a solo day fisherman or a family of four looking to do some extended overnight cruising, the Sportsman model can do the job. The cabin includes a dinette, sleeping accommodation for four, ample storage space and enough room to add galley amenities. The range of options available are virtually limitless and we take pride in the ability to let our customers outfit their boat to suit their needs. All of this combined with a deep-V hull design that will get you there and back comfortably.

FEATURES

- Incredible 22' boat that acts and rides much larger
- Plush seating allows for lounging and cruising
- Spacious V-Berth for comfortable nights and naps
- Legendary Sea Sport hull construction eliminates maintenance concerns
- Economic and robust

THE SPORTSMAN 2200 IS THE SMALLEST IN THE SEA SPORT LINE UP, AND IS VERY POPULAR.

LENGTH	BEAM	FUEL CAPACITY
22'0"	8' 6"	129
SLEEPS	HORSEPOWER	WATER CAPACITY
4	Single 250	22

OVERHEAD

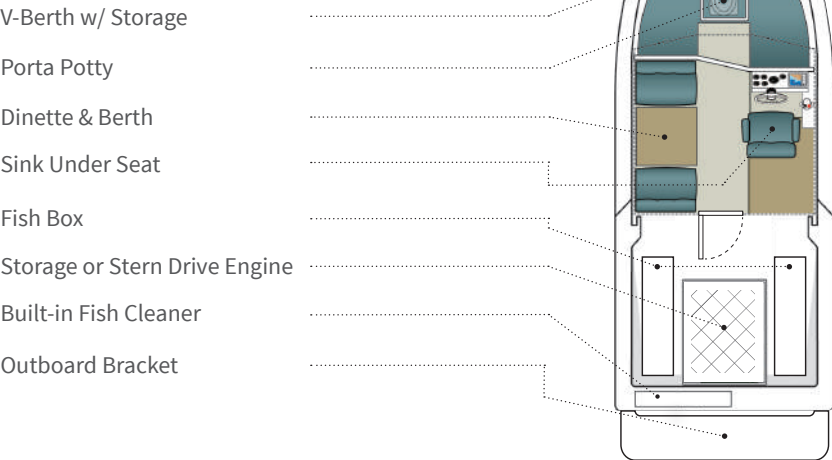





2400 SERIES

ALL THE BELLS AND
WHISTLES FISH
LOVE

MODELS

2

POWER OPTIONS

5

CONFIGURATIONS

5



EXPLORER 2400

THE LEGACY CONTINUES

Added comfort features include an enclosed stand-up head and increased bunk space. The wide walk-around, built in cockpit steps, and a huge hardtop are just a few of the features that you will find on the long list of standards. Whether you are cruising or trophy hunting, in the summer or winter, the Explorer 2400 provides the best performance of any boat in its class due to the signature of the Sea Sport “Deep-V” hull design.

FEATURES

- Wide exterior walk-around eases nerves at the rail
- Unique combination of ride and accommodations
- Sleek Deep-V design creates the smoothest ride in its class
- Thoughtful placement of hatches across large self-bailing deck
- 360 views and natural light through top-of-the-line windows

THE EXPLORER 2400 PROVIDES SPIRITED PERFORMANCE AND A SMOOTH RIDE.

LENGTH

24'0"

BEAM

8' 6"

FUEL CAPACITY

129

SLEEPS

4

HORSEPOWER

Single 250/300
Twin 150

WATER CAPACITY

25

OVERHEAD

V-Berth w/ Storage

Dinette & Berth

Galley

Marine Head

Fish Box

Storage or Stern Drive Engine

Built-in Fish Cleaner

Outboard Bracket

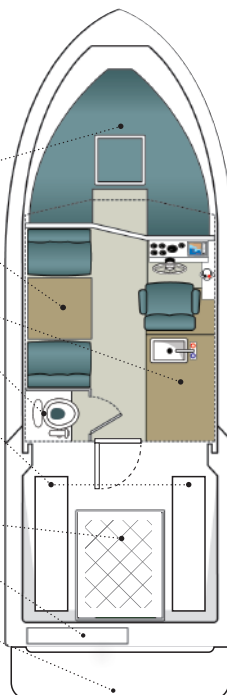



XL 2400

ADVENTURE SEEKER

Built with expert craftsmanship, using the highest quality materials, which is a hallmark of all the Sea Sport models. Just a few of the standard features include a big transom platform, three heavy-duty wipers, dual batteries, trim tabs and more! For your comfort, the XL 2400 has a large fishing or working deck, a warm, dry cabin, a four-person dinette table that converts into a bunk, a generous V-berth, a sink with a pressurized water system, and an optional toilet.

FEATURES

- Huge fishing deck
- Tons of storage for wet or dry needs
- Fish cleaner
- Customizable gunwales for tackle or rod organization

THE XL 2400'S LAYOUT MAKES IT ONE OF THE BEST ALL AROUND BOATS IN ITS CLASS.

LENGTH 24'0"	BEAM 8' 6"	FUEL CAPACITY 149
SLEEPS 4	HORSEPOWER Single 250/300 Twin 150	WATER CAPACITY 25

OVERHEAD

- V-Berth w/ Storage
- Porta Potty
- Dinette & Berth
- Sink Under Seat
- Storage
- Fish Box
- Dry Storage
- Built-in Fish Cleaner
- Outboard Bracket

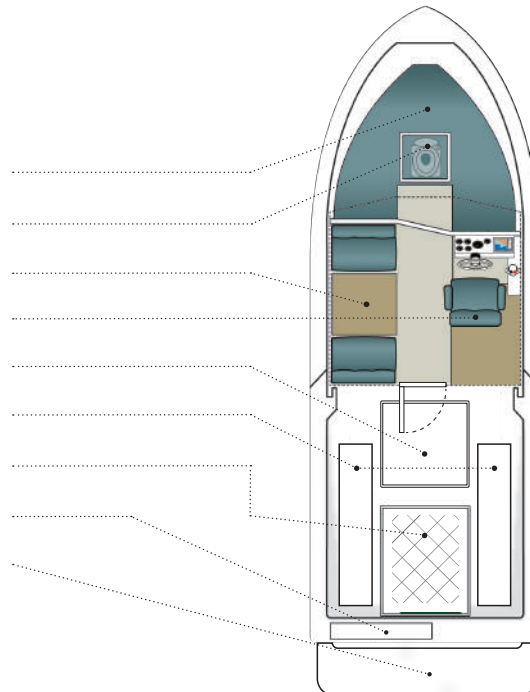





2600 SERIES

THE PERFECT MIX
OF PERFORMANCE,
AND COMFORT

MODELS

4

POWER OPTIONS

5

CONFIGURATIONS

7



ALASKAN PILOT 2600

NORTHERN CLASSIC

The Alaskan Pilot 2600 takes its name from the raised pilothouse designed to provide wide range visibility for the skipper. For the fisherman there is a large deck (55 sqft) with a gunwale-mounted fish cleaning well, and dinghy and crab pot storage are available on the aft roof. For the cruiser who likes to entertain, a full galley with stove options, refrigerator, and sink (with pressurized water); super accommodating for a comfortable weekend out on the water.

FEATURES

- Raised pilothouse for supreme 360 degree visibility
- Multiple exterior storage options
- Full galley including stove options
- Unique style and retro look

THE SEA SPORT ALASKAN PILOT IS A FISHING MACHINE BUILT FOR YEAR ROUND FAMILY FUN!

LENGTH 26'6"	BEAM 8' 6"	FUEL CAPACITY 153
SLEEPS 6	HORSEPOWER Twin 200	WATER CAPACITY 36

OVERHEAD

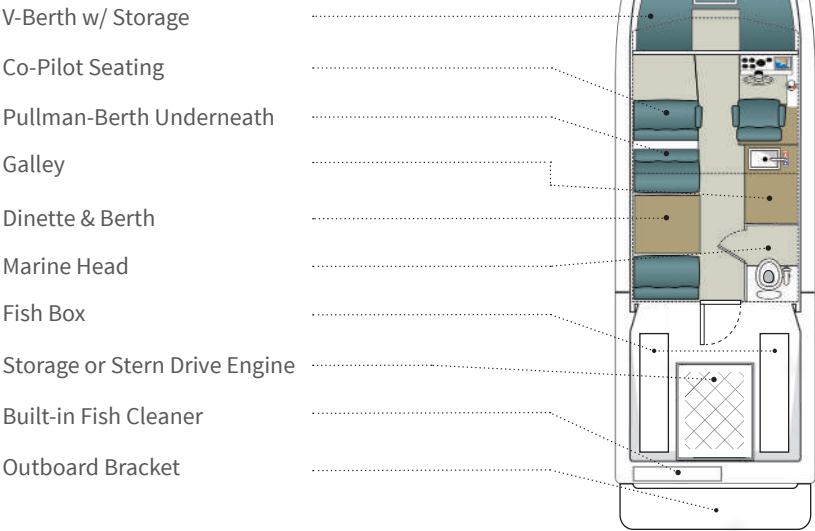



ALEUTIAN 2600

PERFECT FOR FAMILY GATHERINGS

With forward-facing seats, a large dinette, and an enclosed head (with a shower option), the Sea Sport Aleutian 2600 offers plenty of space for four people to enjoy year-round comfort and smooth cruising. The huge hardtop is a great place to store kayaks, bikes and pots. Now you can cruise comfortably in foul weather, yet still enjoy the outdoors on nice weekends. Whether you are out for a day of fishing, or spending a weekend tucked into a favorite cove, the Sea Sport Aleutian 2600 has it all for you.

FEATURES

- Two forward-facing seats
- Huge hardtop for toy storage
- Creature comforts stacked throughout
- LED lighting provides flexibility to enhance your boating experience

THE ALEUTIAN 2600 IS ALL ABOUT VERSATILITY WITH CREATURE COMFORTS STACKED THROUGHOUT.

LENGTH

26'2"

BEAM

8' 6"

FUEL CAPACITY

153

SLEEPS

4

HORSEPOWER

Twin 200

WATER CAPACITY

36

OVERHEAD

V-Berth w/ Storage

Co-Pilot Seating

Sink Under Seat

Galley

Dinette & Berth

Marine Head

Fish Box

Storage or Stern Drive Engine

Built-in Fish Cleaner

Outboard Bracket

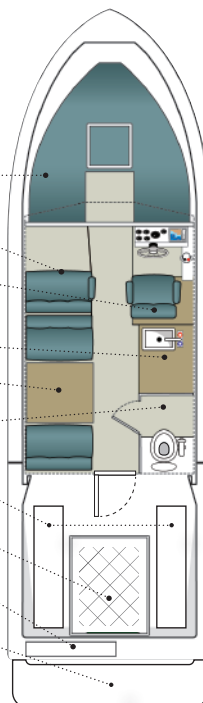



KENAI 2600

DECK ADVANTAGE

First designed with the most serious recreational fishers in mind, the Sea Sport Kenai 2600 is popular amongst charter boats, commercial fishermen, researchers and professional divers. It excels at government agency and patrol applications as well. Outside, there are three storage holds for gear or fish. Inside the roomy cabin, there is a dinette that seats four-and converts into a bunk to sleep two. A sink with pressurized water, a generous V-berth, and a giant back deck with extended range, all make this boat a truly awesome fishing vessel.

FEATURES

- Giant aft deck, customizable to your every need
- Superb hull design providing the smoothest ride in its class
- Best fuel economy within the 2600 series
- GoPro storage and mounting availability
- Optional hanging racks
- Strategic lighting placement for the stealthy angler

DESIGNED USING THOUSANDS OF HOURS OF INSIGHT AND RESEARCH FROM PROFESSIONAL FISHERMEN.

LENGTH

26'2"

BEAM

8' 6"

FUEL CAPACITY

180

SLEEPS

4

HORSEPOWER

Twin 200

WATER CAPACITY

36

OVERHEAD

V-Berth w/ Storage

Porta Potty

Dinette & Berth

Sink Under Seat

Storage

Fish Box

Storage or Stern Drive Engine

Built-in Fish Cleaner

Outboard Bracket

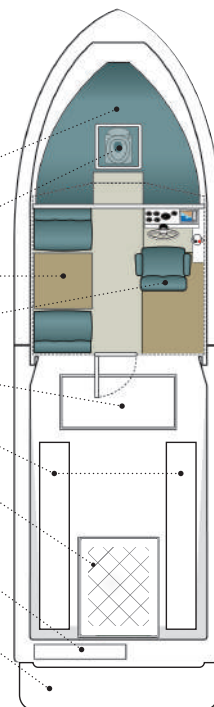



KODIAK 2600

BEST OF BOTH WORLDS

Imagine swinging an anchor in a secluded cove, preparing a hot and delicious meal in a complete galley. Cheerful conversation flows around the dinette, and everyone appreciates the practical convenience of a private, stand-up head. As the sun sinks on the far side of the island, your family is rocked gently to sleep in its comfortable berths. At first light, you'll be trolling for tomorrow night's entree. The dream becomes a reality with a Kodiak 2600.

FEATURES

- Comfortable seating for day trips
- Expansive V-Berth with 6" foam bedding
- Cabin and cockpit lighting that performs and impresses
- Available power options that range from outboard to stern drive

THE KODIAK 2600 IS THE SUPREME HYBRID FOR THE FAMILY CRUISER AND THE AVID FISHERMAN.

LENGTH

26'2"

BEAM

8' 6"

FUEL CAPACITY

180

SLEEPS

4

HORSEPOWER

Twin 200

WATER CAPACITY

36

OVERHEAD

V-Berth w/ Storage

Dinette & Berth

Galley

Marine Head

Fish Box

Storage or Stern Drive Engine

Built-in Fish Cleaner

Outboard Bracket

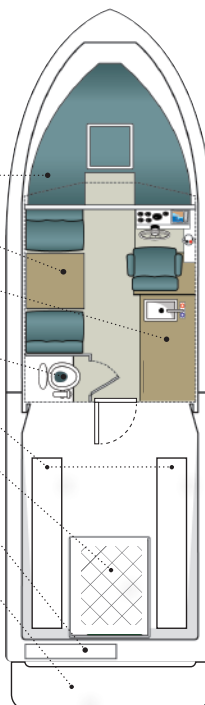





2800 SERIES

THE ULTIMATE IN
RECREATION AND
FISHING

MODELS

1

POWER OPTIONS

5

CONFIGURATIONS

5



COMMANDER 2800

PROUD TRADITION

The Commander 2800 is the newest addition to the Sea Sport lineup and is the perfect size for both leisure family cruising and the diehard fisherman. By adding 2ft in length and 13" in beam, you gain many features that simply were not possible on the 2600 series. The full galley includes a 2-burner propane cooktop and a deep sink with hot and cold water. The cabin also includes a fully enclosed electric marine head and a hot water shower system.

FEATURES

- Huge beam provides an interior feel that is unmatched
- Exceeds expectations for a multi purpose platform
- Forward entry quarter-berth providing sleeping for 2
- Bow thruster option
- Low-profile eliminates windage concerns
- Joy stick controls

THE 2800 COMMANDER REPRESENTS THE EXCELLENCE THAT IS THE HALLMARK OF ALL SEA SPORT BOATS.

LENGTH

28'0"

BEAM

9' 9"

FUEL CAPACITY

300

SLEEPS

6

HORSEPOWER

Twin 300

WATER CAPACITY

60

OVERHEAD

- V-Berth w/ Storage
- Optional Head Forward Design
- Co-Pilot Seating
- Dinette & Berth
- Galley
- Marine Head
- Aft Quarter Berth
- Storage
- Fish Box
- Storage or Stern Drive
- Livewell
- Transom Door
- Outboard Bracket

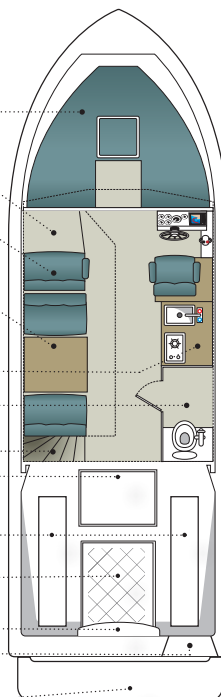



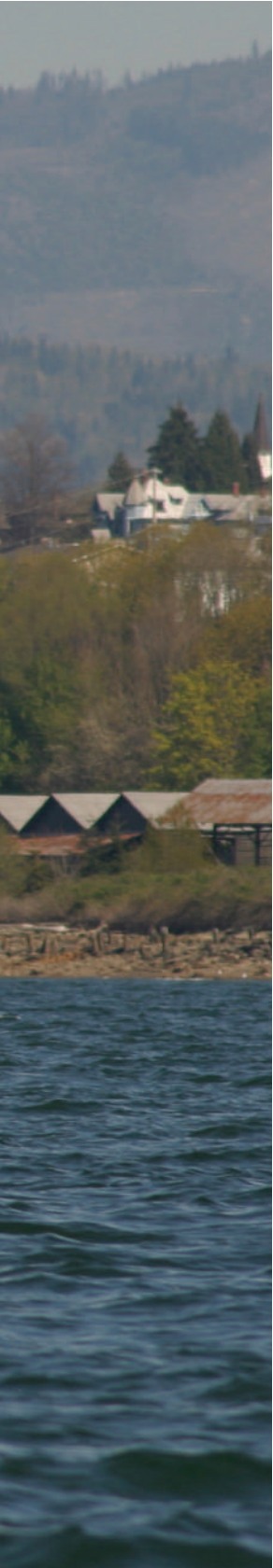

3000 SERIES

REDESIGNED AND
READY FOR YOUR
NEXT CRUISE

MODELS

2

POWER OPTIONS

5

CONFIGURATIONS

5



OFFSHORE 3000

GO FORTH AND PLAY

The Offshore is a world-class sports fisher that boasts optimal performance, speed and a long list of capabilities. Similar to the Voyager 3000, the Offshore combines the benefits of a great fishing boat with all the added luxuries of a pleasure cruiser. With a slightly shorter cabin than the Voyager, the result is a huge 82 sqft aft deck. The additional deck space creates a large fish hold and 2 storage compartments to store your gear. The Offshore 3000 is the extreme sport fishing vessel that will make you the envy of the water.

FEATURES

- New hull characteristics allow for greater fuel efficiency and stability on the water
- Multiple “Social Zones” for entertaining on the flybridge or out on the deck
- Wide beam allows for extremely spacious and fully customizable interior space
- Built to provide high-class fishing and outdoor memories

EVERY ANGLER DREAMS OF THE ULTIMATE FISHING BOAT; THE OFFSHORE CAN MAKE IT A REALITY.

LENGTH

30'0"

BEAM

10' 6"

FUEL CAPACITY

300

SLEEPS

4

HORSEPOWER

Twin 300/350

WATER CAPACITY

60

OVERHEAD

- V-Berth w/ Storage
- Marine Head w/ Shower
- Co-Pilot Seating
- Quarter Berth Underneath
- Dinette & Berth
- Galley
- Fish Box
- Storage
- Storage or Stern Drive Engine
- Transom Door
- Outboard Bracket

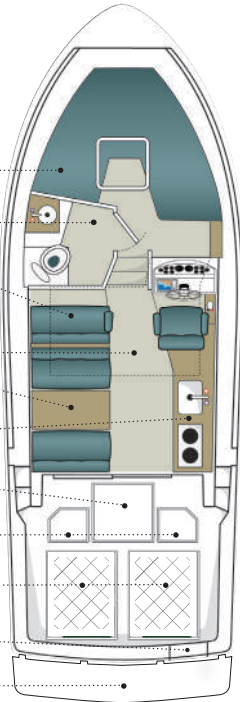



VOYAGER 3000

MASTERFUL PERFORMANCE

The Voyager 3000's spacious cabin offers an enclosed marine head with shower, large V-berth, a full galley with propane stove, microwave oven and a convertible dinette area for easy entertaining. With its thoughtful appointments and intuitive design, the Voyager feels more like a home away from home. The 63 sqft cockpit, coupled with a 10'6" beam, gives you a spacious fishing platform large enough for the whole family. The standard electric windlass lets you anchor in any cove, perfect for finding that secluded, unknown spot.

FEATURES

- New hull characteristics allow for greater fuel efficiency and stability on the water
- Combines performance, seaworthiness, and fishability in an unparalleled way
- Luxurious stateroom and galley
- Extremely maneuverable and responsive

QUALITY CONSTRUCTION WITH FIRST CLASS COMFORT TO CREATE THE ULTIMATE FAMILY CRUISING VESSEL.

LENGTH	BEAM	FUEL CAPACITY
30'0"	10' 6"	300
SLEEPS	HORSEPOWER	WATER CAPACITY
6	Twin 300/350	60

OVERHEAD

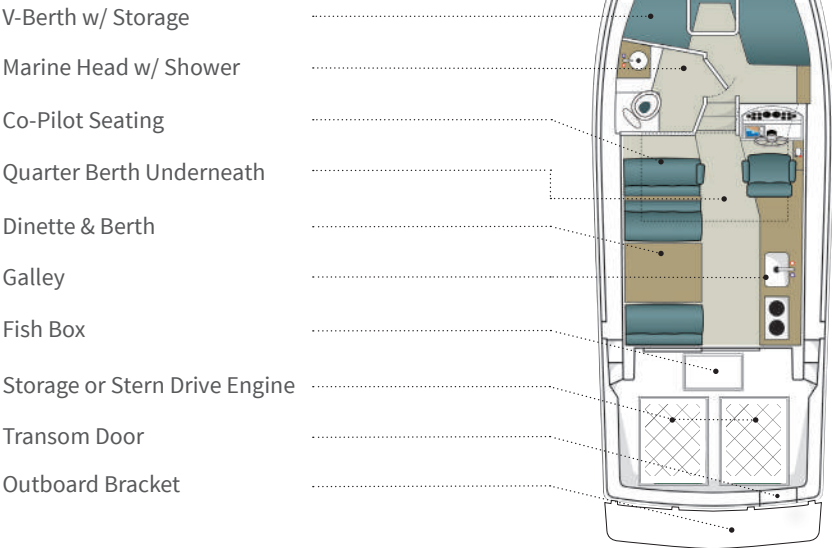





3200 SERIES

A CATAMARAN
WITH CAT-LIKE
REFLEXES

MODELS

1

POWER OPTIONS

5

CONFIGURATIONS

5



BEAUTY & STABILITY

The twin asymmetrical hulls create a high speed, stable, and efficient ride not found in other boats this size. The patented catamaran design greatly reduces side rolls and pitching from wave action. The planing hulls allow you to cruise at 20+ knots, even when the weather turns bad. Reduced drag results in better fuel efficiency, allowing you to go further on a tank of fuel. All of this, gives you the finest built, best handling cruising catamaran in its class.

FEATURES

- Twin-hull Catamaran design bombs through choppy waters with ridiculous ease
- Bow-thruster option and wide motor base makes docking a breeze
- Flybridge offers endless configuration possibilities
- Impressive fuel performance for such a brute with a capacity of 400 gallons with an outboard and 300 with an inboard
- Fully customizable interior layout

THE PACIFIC 3200 IS A UNIQUELY DESIGNED BOAT WITH UNPARALLELED PERFORMANCE.

LENGTH

32'2"

BEAM

12' 10"

FUEL CAPACITY

400

SLEEPS

8

HORSEPOWER

Twin 350

WATER CAPACITY

60

OVERHEAD

- Marine Head w/ Shower
- Main Berth
- Full Galley
- Quarter Berth Underneath
- Dinette & Berth
- Fish Box
- Storage or Stern Drive Engine
- Transom Door
- Outboard Bracket

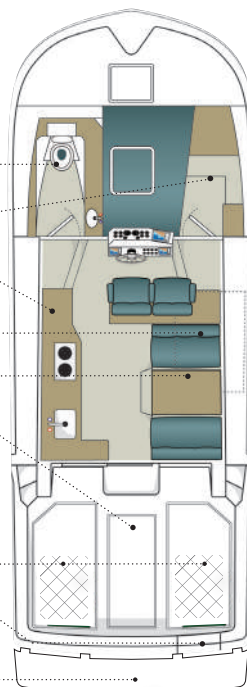



VOYAGER 3000



CUSTOMIZATION OPTIONS

FROM TOP TO BOTTOM, MAKE IT YOURS

From a variety of power options to a great plethora of upholstery swatch features, and from fully customizable layouts to integrated electronics, engine controls, joysticks, bow thrusters and much more, you can truly make your Sea Sport a custom ride.



POWER

We can install any brand and size of motor on the market today, both outboards and inboard/outboards. Since we are not owned by a motor company, we have the flexibility to install whatever you desire.



HONDA



EVINRUDE



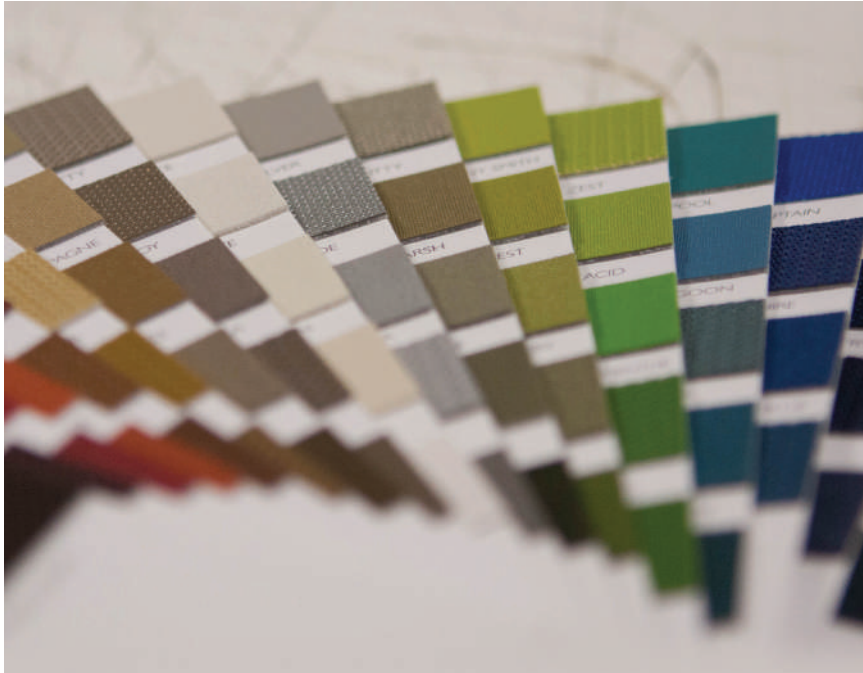

UPHOLSTERY

All tastes are different so we figure we should honor that. Our custom upholstery department can cut, shape, mend, hem any type of fabric in any color or size. We offer a broad range of products to choose from. We can also build custom cushions depending on body frame and preferences.



AESTHETICS

Selecting the right color combination for your Sea Sport is often not easy as they all look so glorious. We can mock up different color options and layouts to fit any desire, as long as the colors are offered by our suppliers. We also can match you up with real life color chips to make sure the choice is right for you.



CONFIGURATIONS

Sea Sport offers custom interior layouts for all models. Typical adjustments are bench seating, head locations, quarter berths, height modifications, etc. Please don't hesitate to ask if you have an idea that you think may work for you and your situation and we'll likely find a way to accommodate. Again, this is what sets Sea Sport apart from our competition – custom boats to fit your wish list.



ACCESSORIES

Lights, tackle boxes, wood trim are a few of the many options we can discuss getting into the boat at the factory. We enjoy building custom boats that can be completely personalized to suit your needs. Our boats are built by hand for each individual owner and getting to this level of detail is what differentiates Sea Sport from the other boats.



EQUIPMENT

There are some really nice additions that you can have us install at the factory, from pole holders to anchor windlasses. We take you through our equipment lists and talk about locations, operations, and functionality and suit the equipment to your needs, not just to a universal boat specification.

	2200	2400		2600				2800	3000		3200
GENERAL SPECIFICATIONS	SPORTSMAN	XL	EXPLORER	KENAI	KODIAK	ALEUTIAN	ALASKAN PILOT	COMMANDER	OFFSHORE	VOYAGER	PACIFIC
LOA	22'0"	24'0"	24'0"	26'2"	26'2"	26'2"	26'6"	28'0"	30'0"	30'0"	32'2"
Beam	8'6"	8'6"	8'6"	8'6"	8'6"	8'6"	8'6"	9'9"	10'6"	10'6"	12'10"
Draft (motors up)	22"	22"	22"	22"	22"	22"	22"	22"	25.5"	25.5"	28"
Draft (motors down)	39"	39"	39"	39"	39"	39"	39"	39"	33"	33"	40"
Approximate Dry Weight	4,200lbs	5,000lbs	5,500lbs	5,400lbs	5,750lbs	5,850lbs	6,050lbs	10,000lbs	12,000lbs	12,000lbs	16,000lbs
Holding Tank Capacity	8 US gal.	8 US gal.	8 US gal.	12 US gal.	12 US gal.	12 US gal.	12 US gal.	30 US gal.	30 US gal.	30 US gal.	30 US gal.
Water Capacity	25 US gal.	25 US gal.	25 US gal.	36 US gal.	36 US gal.	36 US gal.	36 US gal.	60 US gal.	60 US gal.	60 US gal.	60 US gal.
Fuel Capacity	129 US gal.	149 US gal.	129 US gal.	180 US gal.	180 US gal.	153 US gal.	153 US gal.	300 US gal.	300 US gal.	300 US gal.	400 US gal.
Sleeping Capacity	4	4	4	4	4	4	6	6	4	6	8
Deadrise	22°	22°	22°	22°	22°	22°	22°	22°	22°	22°	22°

COMFORT AND INTERIOR

Quarter Berth	N/A	N/A	N/A	N/A	N/A	N/A	N/A	OPT	N/A	STD	STD
Air Conditioning - single unit 16,500 BTU	N/A	N/A	OPT	OPT	OPT	OPT	OPT	OPT	OPT	OPT	OPT
Bunk And Dinette Cushions 4"	STD	STD	STD	STD	STD	STD	STD	STD	STD	STD	STD
Chart Rack	OPT	OPT	OPT	OPT	OPT	OPT	OPT	OPT	OPT	OPT	OPT
Curtains (snap set)	OPT	OPT	OPT	OPT	OPT	OPT	OPT	OPT	OPT	OPT	OPT
Curtains (with track)	OPT	OPT	OPT	OPT	OPT	OPT	OPT	OPT	OPT	OPT	OPT
Deep Sink and Faucet	STD	STD	STD	STD	STD	STD	STD	STD	STD	STD	STD
Diesel Webasto Furnace	OPT	OPT	OPT	OPT	OPT	OPT	OPT	OPT	OPT	OPT	OPT
Formica Table And Counter Top	STD	STD	STD	STD	STD	STD	STD	STD	STD	STD	STD
Heater With Defrost (I/O)	STD	STD	STD	STD	STD	STD	STD	STD	STD	STD	STD
Louvered Doors In Dinette	STD	STD	STD	STD	STD	STD	STD	OPT	OPT	OPT	OPT
Marine Floor Carpeting	STD	STD	STD	STD	STD	STD	STD	STD	STD	STD	STD
Marine Head w/ holding tank, pump out, and Macerator	OPT	OPT	STD	OPT	STD	STD	STD	STD	STD	STD	STD
Microwave Oven	N/A	N/A	OPT	OPT	OPT	OPT	OPT	OPT	STD	STD	STD
Porta Potty	STD	STD	OPT	STD	OPT	OPT	OPT	OPT	OPT	OPT	OPT
Refrigerator	OPT	OPT	STD	OPT	STD	STD	STD	STD	STD	STD	STD
Running Lights	STD	STD	STD	STD	STD	STD	STD	STD	STD	STD	STD
Shower (includes hot water tank)	OPT	OPT	OPT	OPT	OPT	OPT	OPT	STD	STD	STD	STD

	2200	2400		2600				2800	3000		3200
COMFORT AND INTERIOR	SPORTSMAN	XL	EXPLORER	KENAI	KODIAK	ALEUTIAN	ALASKAN PILOT	COMMANDER	OFFSHORE	VOYAGER	PACIFIC
Stereo	OPT	OPT	OPT	OPT	STD	STD	STD	STD	STD	STD	STD
Stove (propane w/ cooktop, oven, tank and switch, exchange)	OPT	OPT	OPT	OPT	OPT	OPT	OPT	OPT	OPT	OPT	OPT
Stove (diesel cooktop blower, exchange)	OPT	OPT	OPT	OPT	OPT	OPT	OPT	OPT	OPT	OPT	OPT
Swim Step Ladder, Retractable 3-step	OPT	OPT	OPT	OPT	OPT	OPT	OPT	OPT	OPT	OPT	OPT
Teak and Holly Floor	OPT	OPT	OPT	OPT	OPT	OPT	OPT	OPT	OPT	OPT	OPT
V-Berth Shelves	OPT	OPT	OPT	OPT	OPT	OPT	OPT	STD	STD	STD	STD
Washdown Pump	OPT	OPT	OPT	OPT	OPT	OPT	OPT	STD	STD	STD	STD
Water Tank	STD	STD	STD	STD	STD	STD	STD	STD	STD	STD	STD

HULL, DECK AND COCKPIT

Aft Console Steering & Controls	OPT	OPT	OPT	OPT	OPT	OPT	OPT	OPT	OPT	OPT	OPT
Aft Console with Steering Only	OPT	OPT	OPT	OPT	OPT	OPT	OPT	OPT	OPT	OPT	OPT
Aft Deck Work Light	OPT	OPT	OPT	OPT	OPT	OPT	OPT	OPT	OPT	OPT	OPT
Aft Hardtop Rail	OPT	OPT	OPT	OPT	OPT	OPT	OPT	OPT	OPT	OPT	OPT
Aluminum Gunnel Trim	STD	STD	STD	STD	STD	STD	STD	N/A	N/A	N/A	N/A
Anchor Well and Deck Pipe	STD	STD	STD	STD	STD	STD	STD	STD	STD	STD	STD
Cabin and V-Berth Hull Liner	STD	STD	STD	STD	STD	STD	STD	STD	STD	STD	STD
Cockpit Boltsters	OPT	OPT	OPT	OPT	OPT	OPT	OPT	OPT	OPT	OPT	STD
Cockpit Courtesy Lights	STD	STD	STD	STD	STD	STD	STD	STD	STD	STD	STD
Cockpit Rail (full u-shaped)	OPT	OPT	OPT	OPT	OPT	OPT	OPT	OPT	OPT	OPT	OPT
Cockpit Rail (full u-shaped) w/ downriggers	OPT	OPT	OPT	OPT	OPT	OPT	OPT	OPT	OPT	OPT	OPT
Fish Box Pump	STD	STD	STD	STD	STD	STD	STD	STD	STD	STD	STD
Folding Step (into cabin)	OPT	OPT	OPT	OPT	OPT	OPT	OPT	N/A	N/A	N/A	N/A
Forward Facing Seat	OPT	OPT	OPT	OPT	OPT	STD	OPT	STD	STD	STD	STD
Full Walk Around Deck	STD	STD	STD	STD	STD	STD	STD	STD	STD	STD	STD
Raw Water Wash Down	OPT	OPT	OPT	OPT	OPT	OPT	OPT	STD	STD	STD	STD
Refer Small	OPT	OPT	STD	OPT	STD	STD	STD	OPT	OPT	OPT	OPT
Refer Large	N/A	N/A	OPT	OPT	OPT	OPT	OPT	STD	STD	STD	STD
Rod Holder (flush mount)	OPT	OPT	OPT	OPT	OPT	OPT	OPT	OPT	OPT	OPT	OPT
Rub Guard Heavy Duty	OPT	OPT	OPT	OPT	OPT	OPT	OPT	STD	STD	STD	STD

	2200	2400		2600				2800	3000		3200
HULL, DECK AND COCKPIT	SPORTSMAN	XL	EXPLORER	KENAI	KODIAK	ALEUTIAN	ALASKAN PILOT	COMMANDER	OFFSHORE	VOYAGER	PACIFIC
Self Bailing Cockpit	STD	STD	STD	STD	STD	STD	STD	STD	STD	STD	STD
Sliding Bulkhead Door (exchange)	OPT	OPT	OPT	OPT	OPT	OPT	OPT	OPT	OPT	OPT	STD
S.S. Rails	STD	STD	STD	STD	STD	STD	STD	STD	STD	STD	STD
S.S. Bow Roller	STD	STD	STD	STD	STD	STD	STD	STD	STD	STD	STD
S.S. Cleats	STD	STD	STD	STD	STD	STD	STD	STD	STD	STD	STD
Stern Fish Cleaner	STD	STD	STD	STD	STD	STD	STD	N/A	N/A	N/A	N/A
Tinted Windows	STD	STD	STD	STD	STD	STD	STD	STD	STD	STD	STD
Transom Door	OPT	OPT	OPT	OPT	OPT	OPT	OPT	STD	STD	STD	STD
Windlass	OPT	OPT	OPT	OPT	OPT	OPT	OPT	STD	STD	STD	STD

INSTRUMENTATION AND SAFETY

Automatic Bilge Pump	STD	STD	STD	STD	STD	STD	STD	STD	STD	STD	STD
Bait Tank	N/A	OPT	OPT	OPT	OPT	OPT	OPT	STD	N/A	N/A	OPT
Battery Upgrade 4D	OPT	OPT	OPT	OPT	OPT	OPT	OPT	OPT	OPT	OPT	OPT
Bilge Pump	STD	STD	STD	STD	STD	STD	STD	STD	STD	STD	STD
Bow Thruster	N/A	N/A	N/A	N/A	N/A	N/A	N/A	OPT	OPT	OPT	OPT
Compass	OPT	OPT	OPT	OPT	OPT	OPT	OPT	OPT	OPT	OPT	OPT
D.C. Switch Panel	STD	STD	STD	STD	STD	STD	STD	STD	STD	STD	STD
Dual Batteries	STD	STD	STD	STD	STD	STD	STD	STD	STD	STD	STD
Electric Head	OPT	OPT	OPT	OPT	OPT	OPT	OPT	STD	STD	STD	STD
Electric Horn	STD	STD	STD	STD	STD	STD	STD	STD	STD	STD	STD
Electric Wipers	STD	STD	STD	STD	STD	STD	STD	STD	STD	STD	STD
Fuel Filters	STD	STD	STD	STD	STD	STD	STD	STD	STD	STD	STD
Generator	N/A	N/A	N/A	OPT	OPT	OPT	OPT	OPT	OPT	OPT	OPT
Hydraulic Steering	STD	STD	STD	STD	STD	STD	STD	STD	STD	STD	STD
Inverter	OPT	OPT	OPT	OPT	OPT	OPT	OPT	OPT	OPT	OPT	OPT
Kicker Tank	OPT	OPT	OPT	OPT	OPT	OPT	OPT	OPT	OPT	OPT	OPT
Radar Arch (fixed)	OPT	OPT	OPT	OPT	OPT	OPT	OPT	OPT	OPT	OPT	OPT
Radar Arch (hinged)	OPT	OPT	OPT	OPT	OPT	OPT	OPT	OPT	OPT	OPT	OPT
Shore Power With Charger	OPT	OPT	STD	OPT	STD	STD	STD	STD	STD	STD	STD
Spotlight Remote Control	OPT	OPT	OPT	OPT	OPT	OPT	OPT	OPT	OPT	OPT	OPT

	2200	2400		2600				2800	3000		3200
INSTRUMENTATION AND SAFETY	SPORTSMAN	XL	EXPLORER	KENAI	KODIAK	ALEUTIAN	ALASKAN PILOT	COMMANDER	OFFSHORE	VOYAGER	PACIFIC
Tilt Helm	OPT	OPT	OPT	OPT	OPT	OPT	OPT	STD	STD	STD	STD
Trim Tabs	STD	STD	STD	STD	STD	STD	STD	STD	STD	STD	STD
Waste and Water Monitors	OPT	OPT	OPT	OPT	OPT	OPT	OPT	STD	STD	STD	STD
Window Washers	OPT	OPT	OPT	OPT	OPT	OPT	OPT	OPT	STD	STD	STD

COLOR SELECTION

Custom Gunnel Stripe	OPT	OPT	OPT	OPT	OPT	OPT	OPT	OPT	OPT	OPT	OPT
Custom Hull Color	OPT	OPT	OPT	OPT	OPT	OPT	OPT	OPT	OPT	OPT	OPT
Fabric Packages to Match Gel-coat Colors	OPT	OPT	OPT	OPT	OPT	OPT	OPT	OPT	OPT	OPT	OPT

All specifications, features and options subject to change without notice



WARRANTY AND OWNERSHIP

As a family owned business we take our reputation very seriously. Our warranty is more than just words and a sales tool. If you have a problem, please feel free to call our factory and talk with one of our owners. We will get to the bottom of the issue and correct it. No other boat in our class can touch our coverage, our level of support, and our commitment to you as a boat owner.

- 10 Year Structural Warranty
- 5 Year Vessel Factory Component Warranty
- 3 Year Gelcoat Finish Warranty



SeaSport

YOU'VE WAITED LONG ENOUGH

MADE IN  THE USA

809 HARRIS AVENUE, BELLINGHAM, WA 98225 PH 360-389-5351 FAX 360-419-4362 WWW.SEASPORTBOATS.COM

Photo Courtesy of Kurt Smith